

**HOBART**

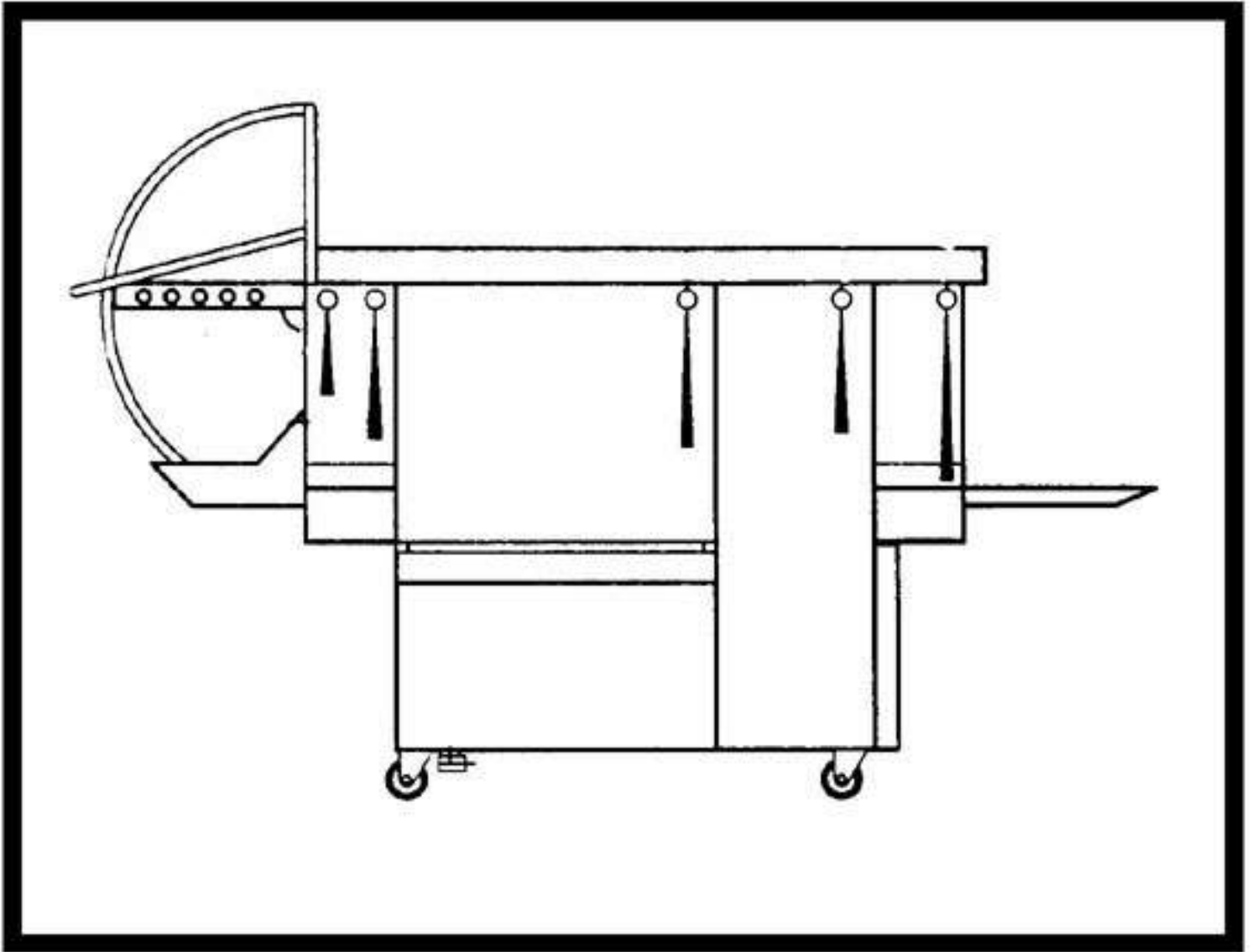

**UCX**

UCX

Extended hood - loading section  
Sas entrée  
Vorhaube - Zulauf  
Kap - toevoer

**HOBART**

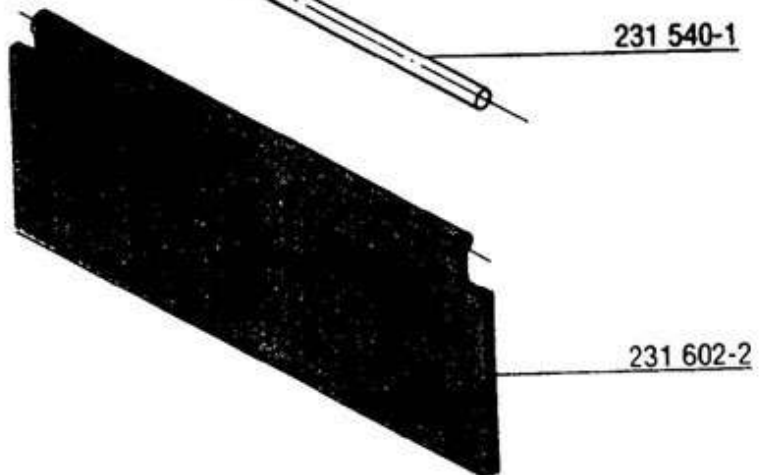
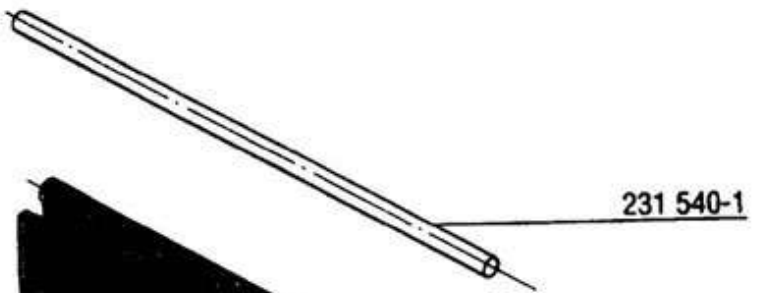
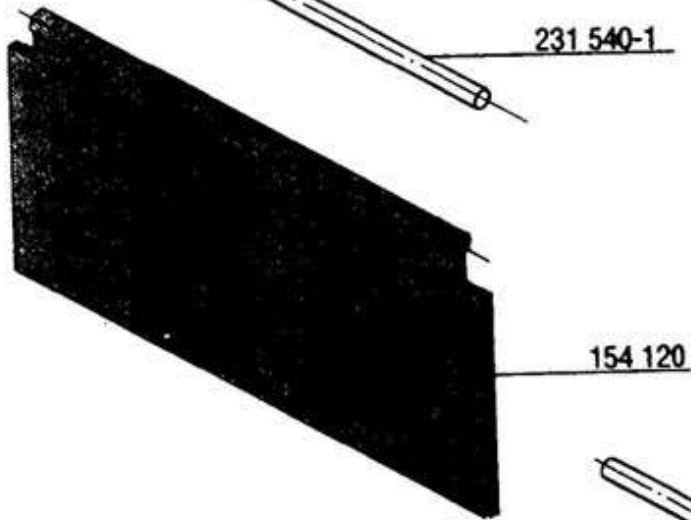
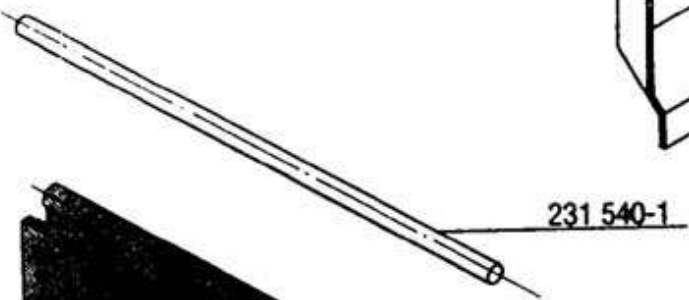
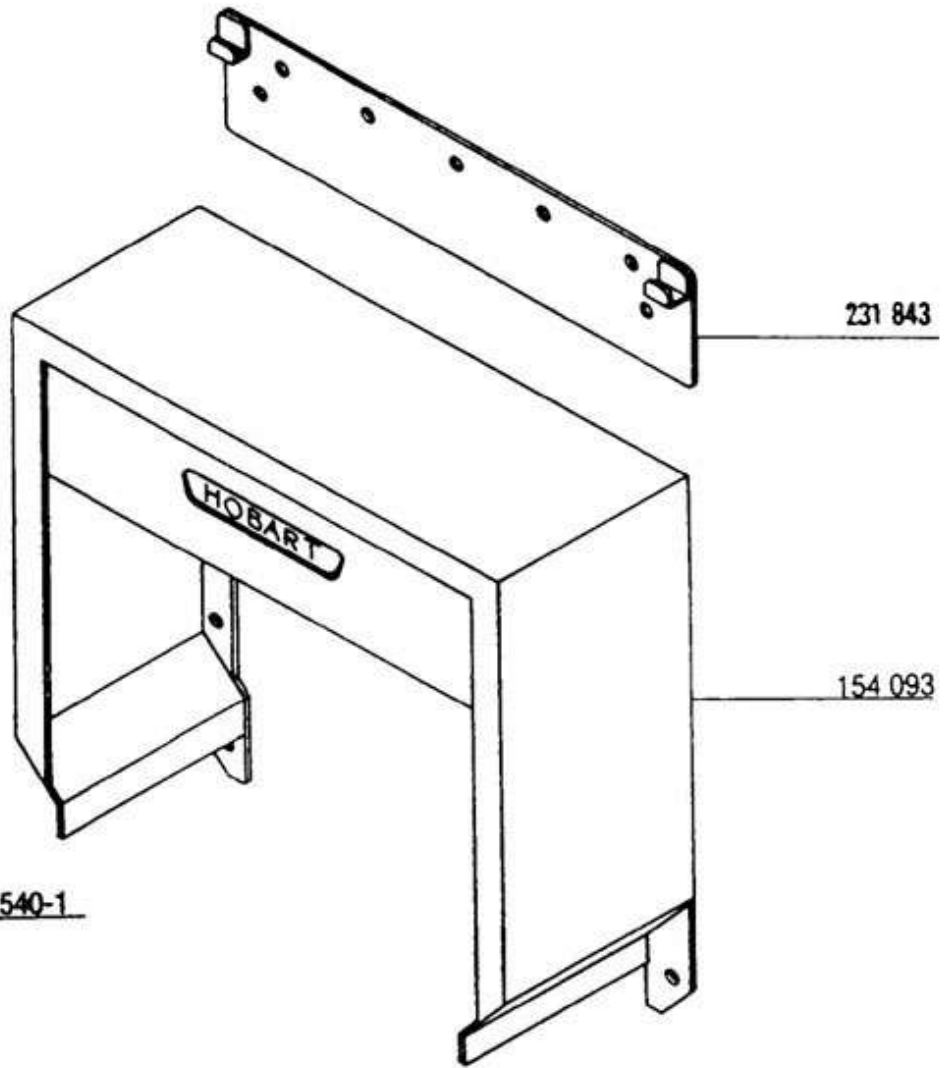
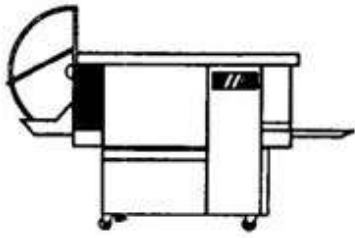



Extended hood - unloading section  
Sas de sortie  
Vorhaube - Auslauf  
Kap - afvoer

UCX

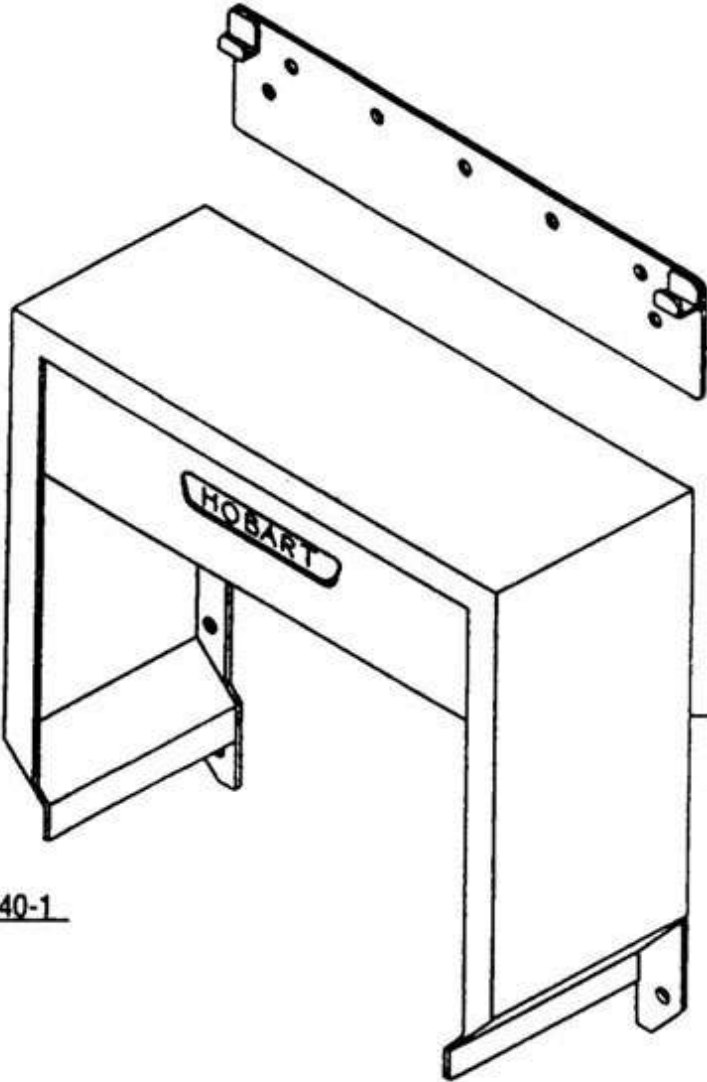
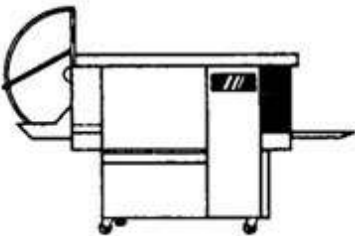

231 843

154 093

231 540-1

230 781

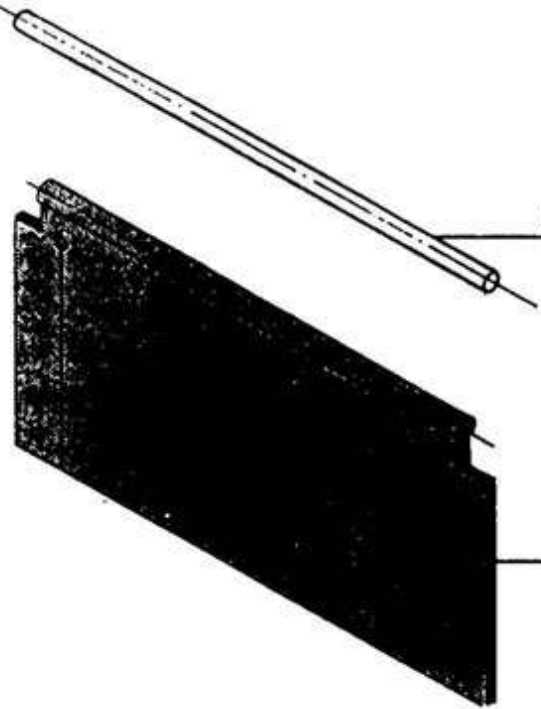

UCX

Side panels.  
Panneaux de latéraux  
Seitenverkleidung  
Zijdelingse bekleidingen

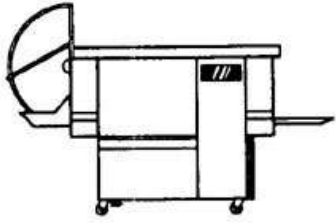

230 952-1 L/R  
230 952-2 R/L

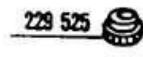
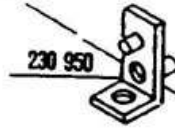
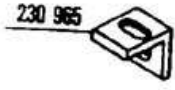
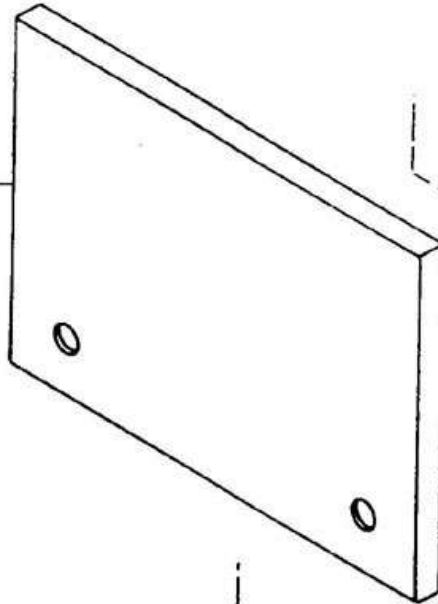

230 930

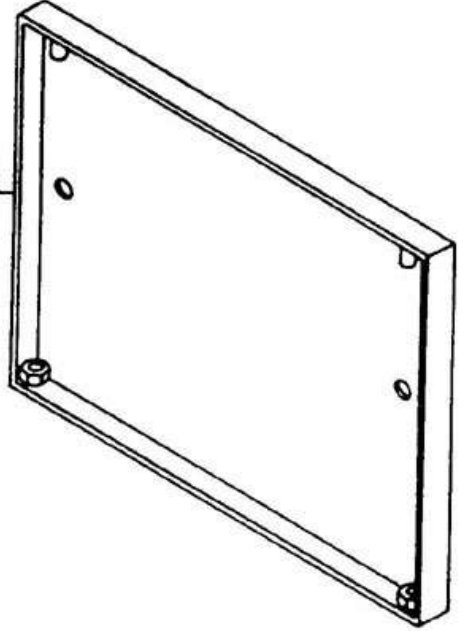

230 953

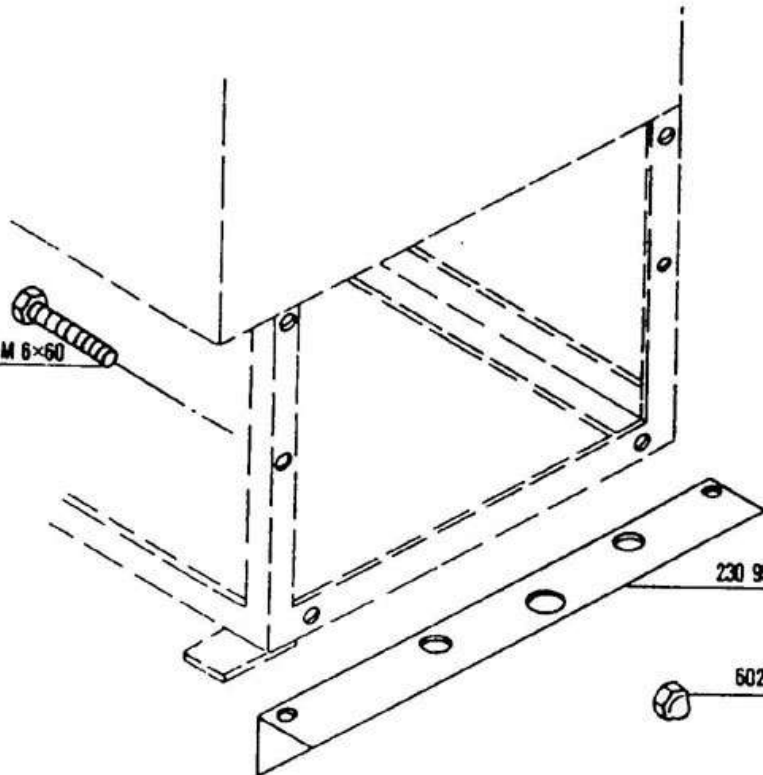
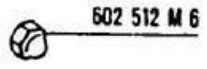

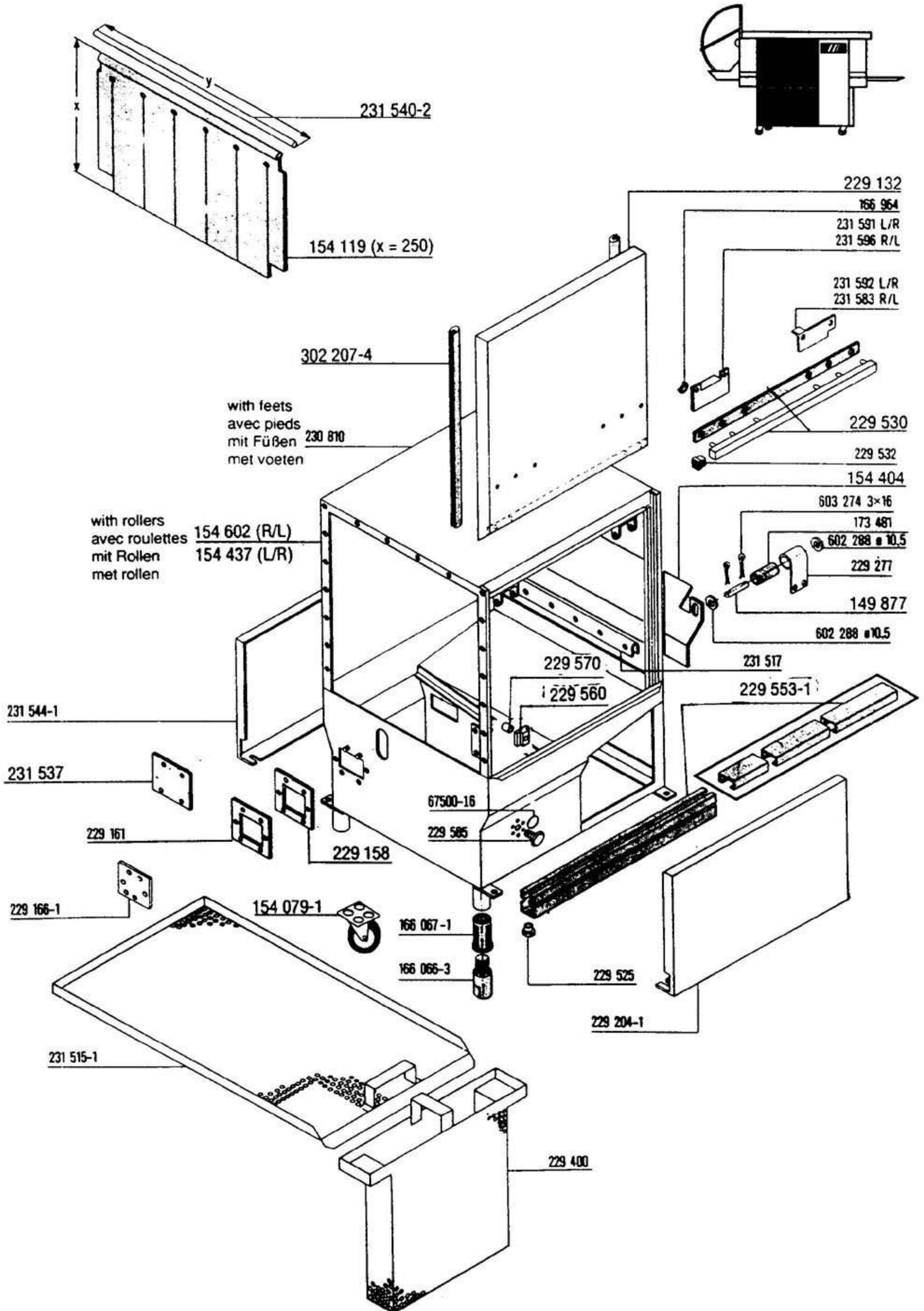

# UCX

Pump (900 mm module)  
Pompe (module de 900 mm)  
Waschpumpe (900 mm Segment)  
Waspomp (900 mm segment)

# HOBART

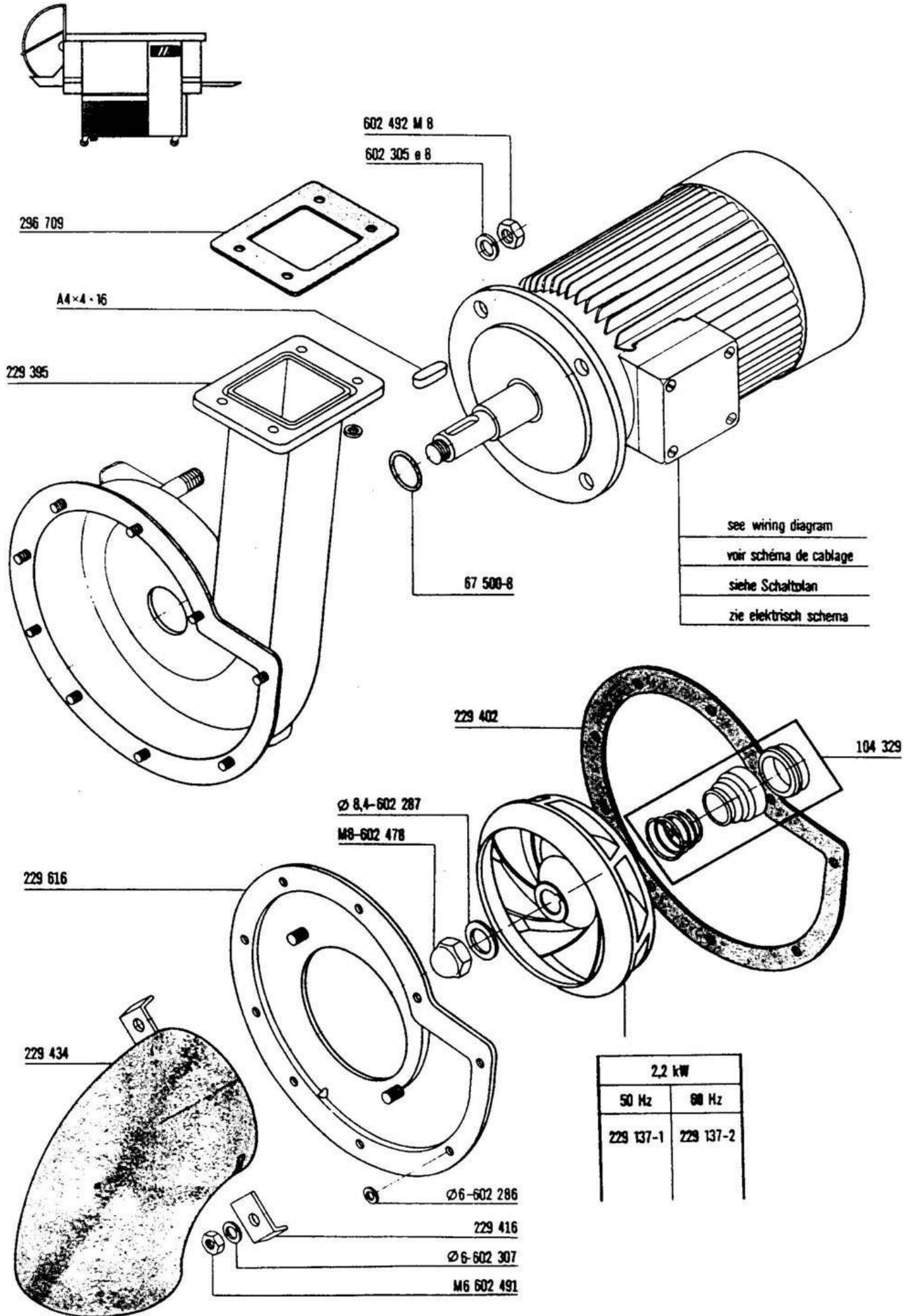

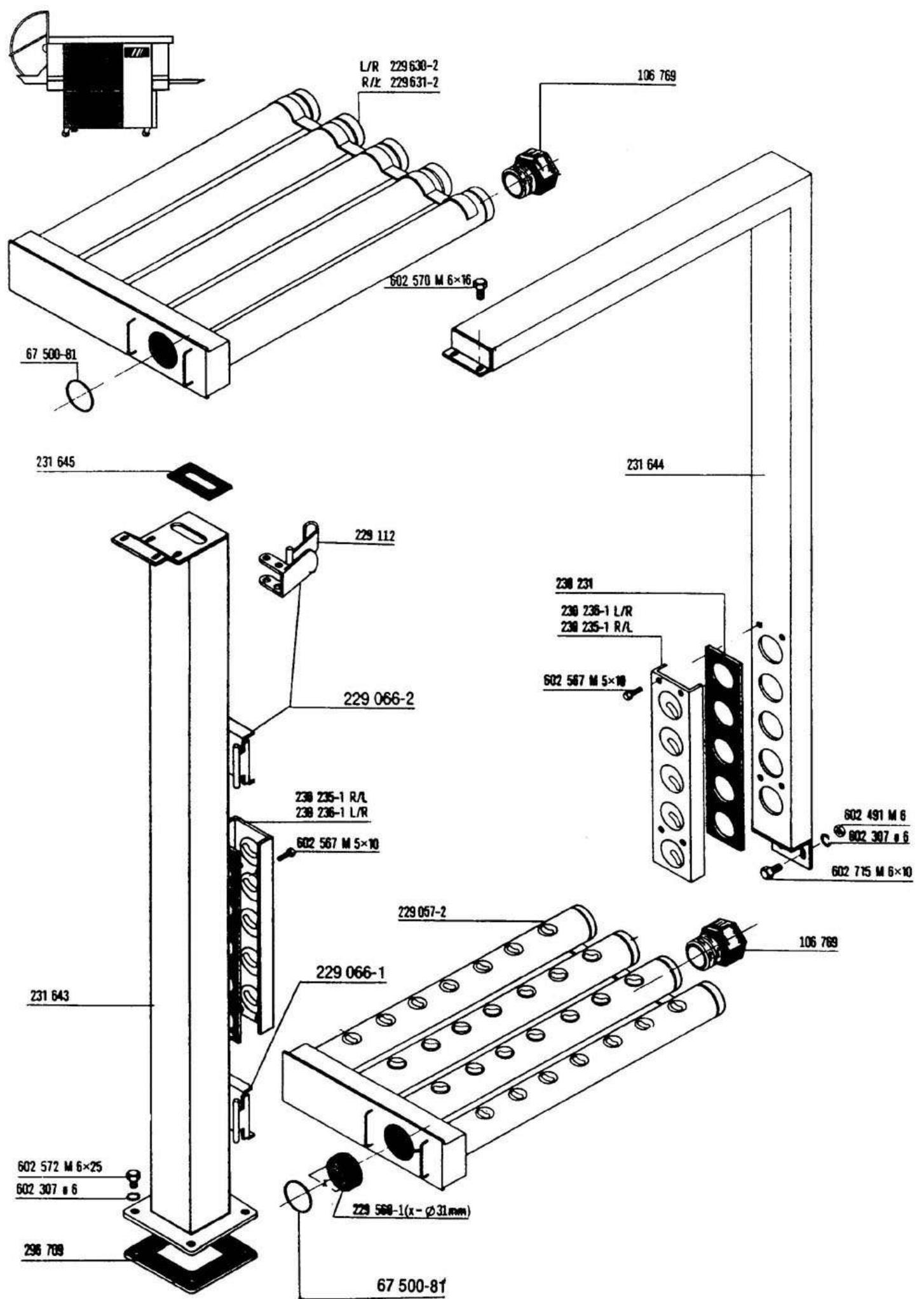

UCX

Drain  
Vidange  
Ablauf  
Afvoer

**HOBART**

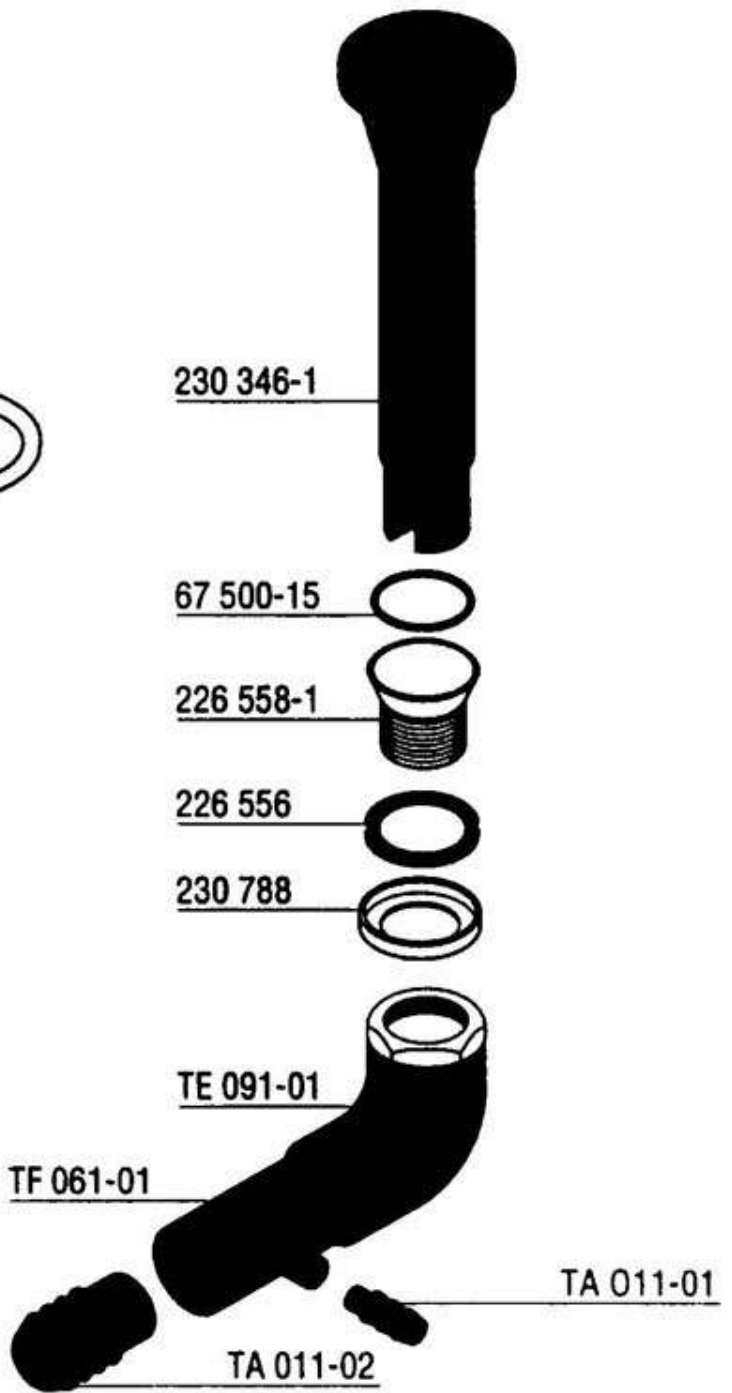
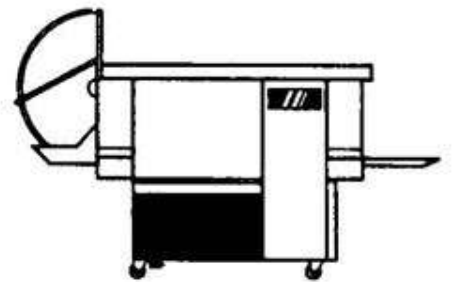
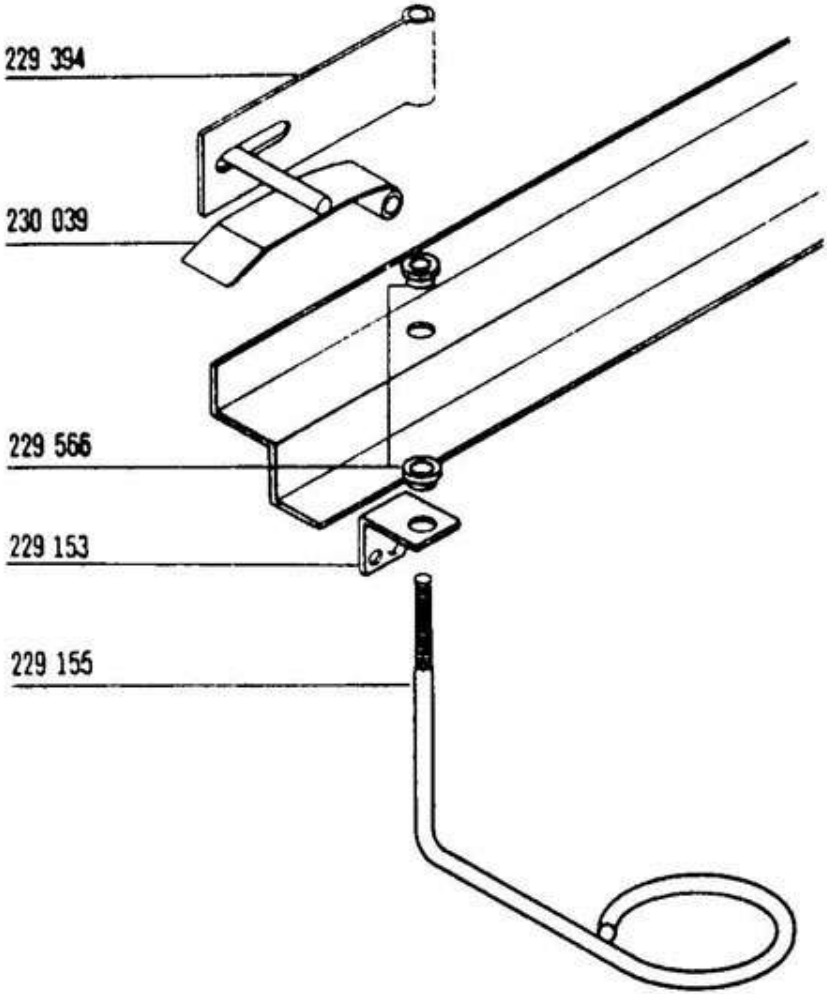





Tank heating & floatswitch  
 Chauffage du bac & interrupteur à flotteur  
 Tankheizung - Schwimmer-Schalter  
 Tankverwarming & niveauschakelaar

UCX

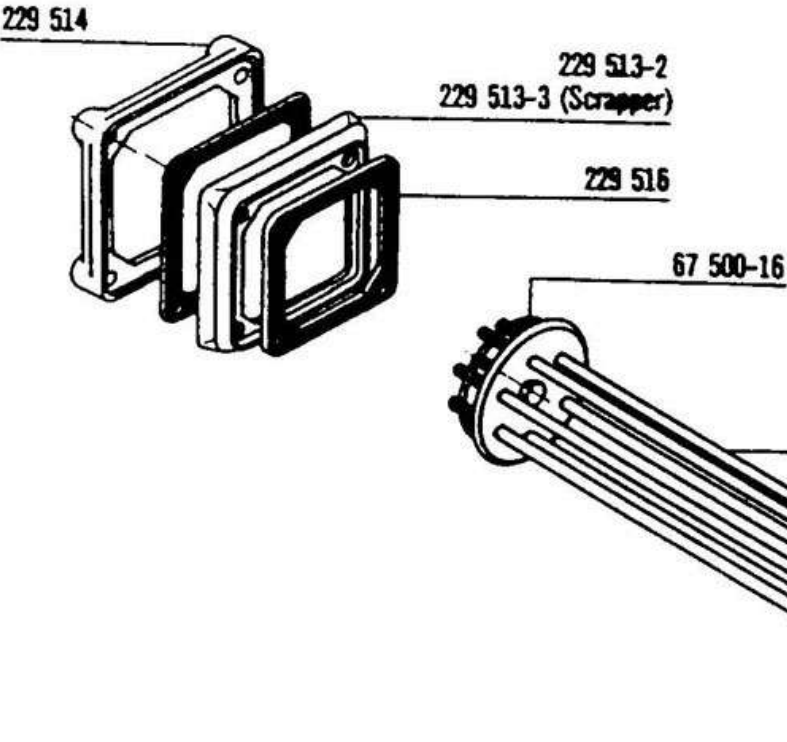
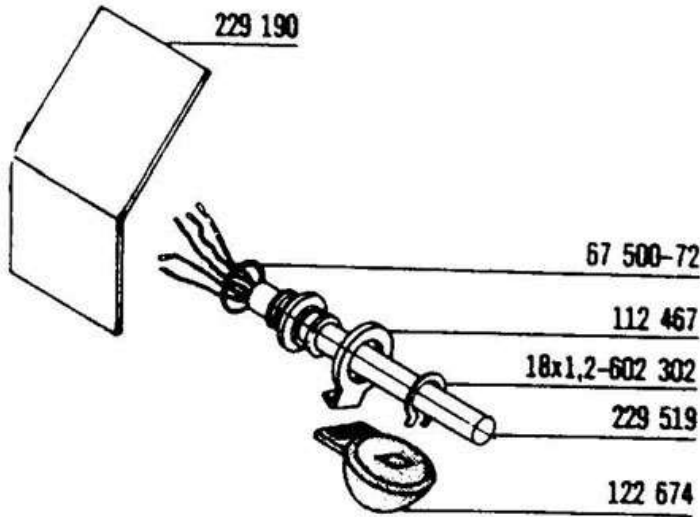
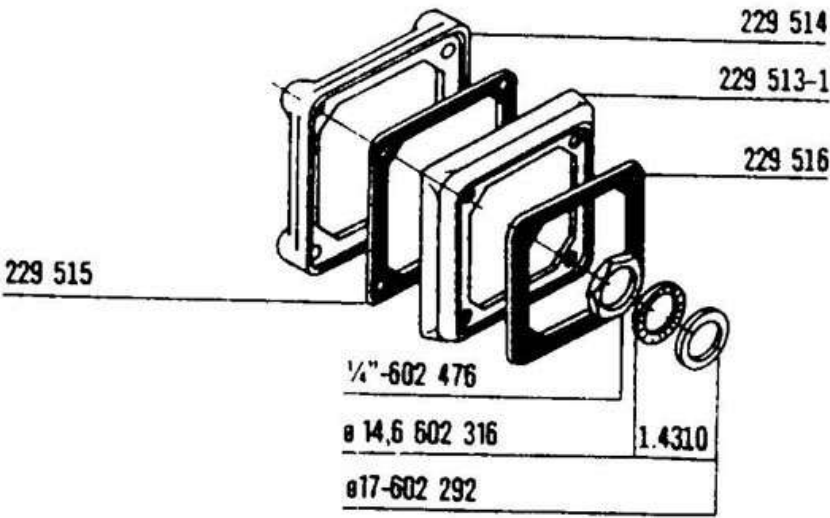
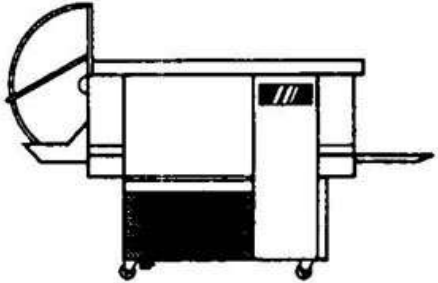

see wiring diagram  
 voir schéma de cablage  
 siehe Schaltplan  
 zie elektrisch schema

# UCX

Tank heating - hot water / steam  
Chauffage du bac - eau surchauffée / vapeur  
Tankheizung - Heißwasser / Dampf  
Tankverwarming - heet water / stoom

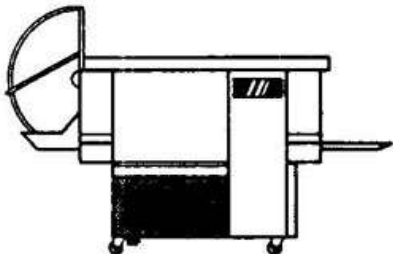

see wiring diagram  
voir schéma de câblage  
siehe Schaltplan  
zie elektrisch schema

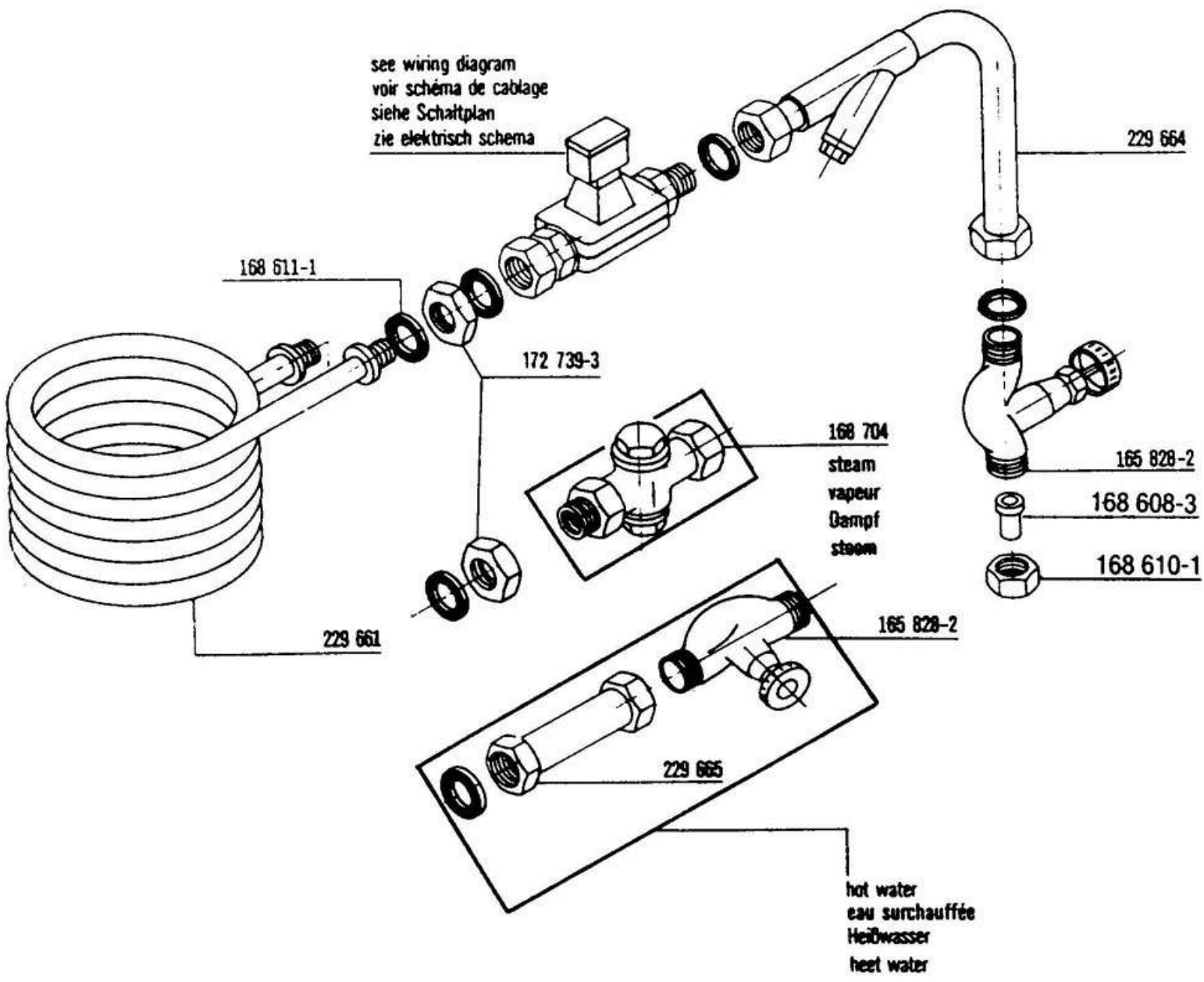

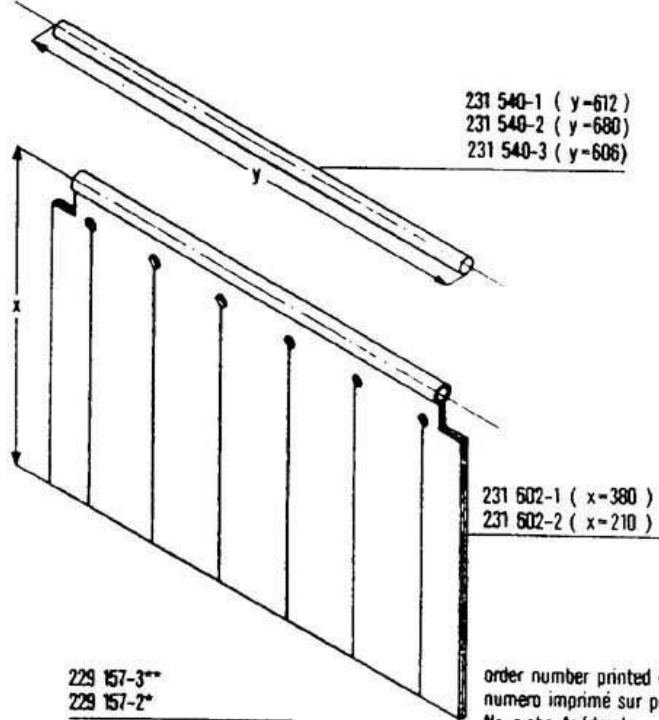
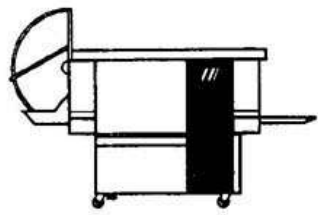

with feet  
 154 108 avec pieds  
 mit Füßen

154 438 (R/L) with rollers  
 avec roulettes

154 439 (L/R) mit Rollen

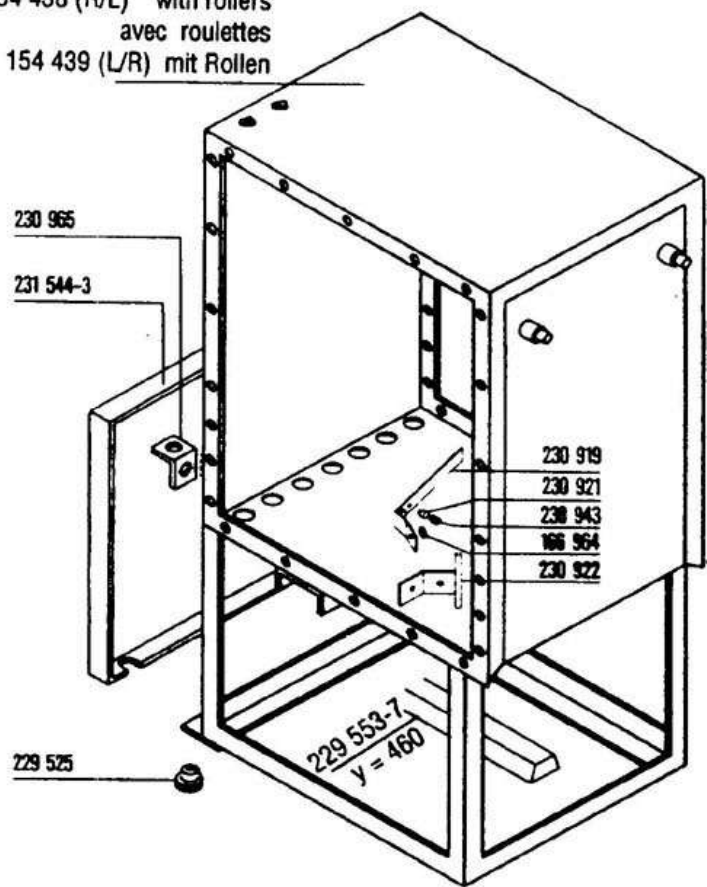

229 157-3\*\*  
 229 157-2\*

229 167-1 (220-260 V )

229 048

229 169 (4 m)

230 733

order number printed on part  
 numero imprimé sur piece  
 Nr. siehe Aufdruck  
 nummer afgedrukt

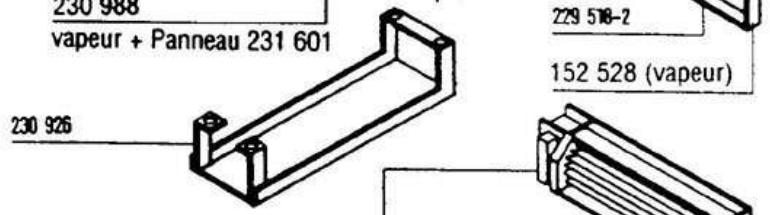
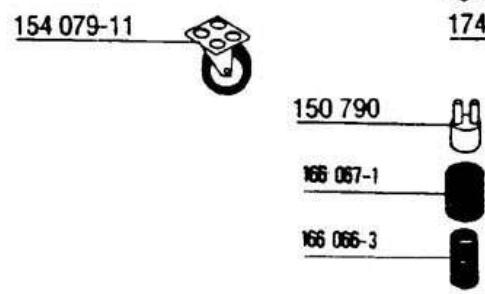
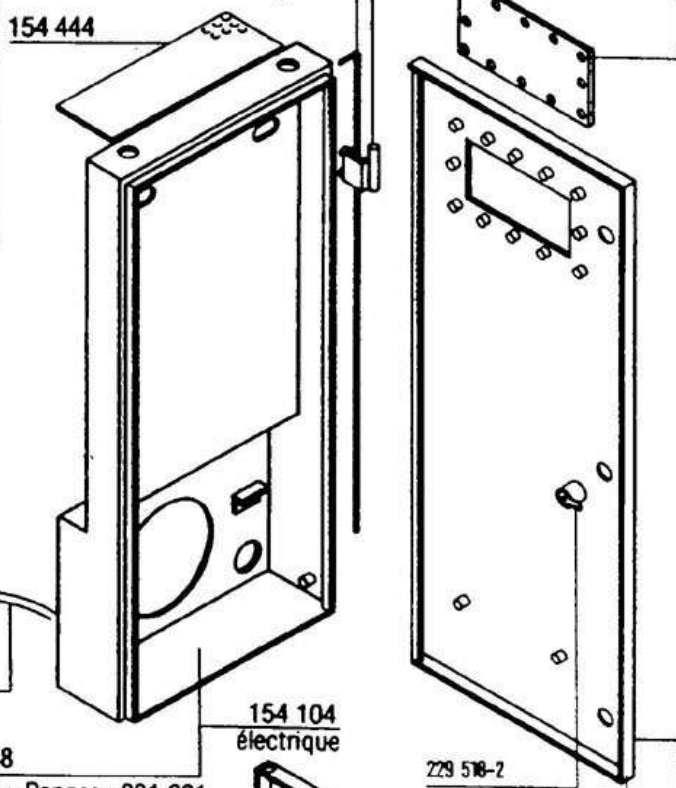

\*\* yellow, jaune, gelb, geel  
 \* green, vert, grün, groen

see wiring diagram  
 voir schéma de cablage  
 siehe Schaltplan  
 zie elektrisch schema

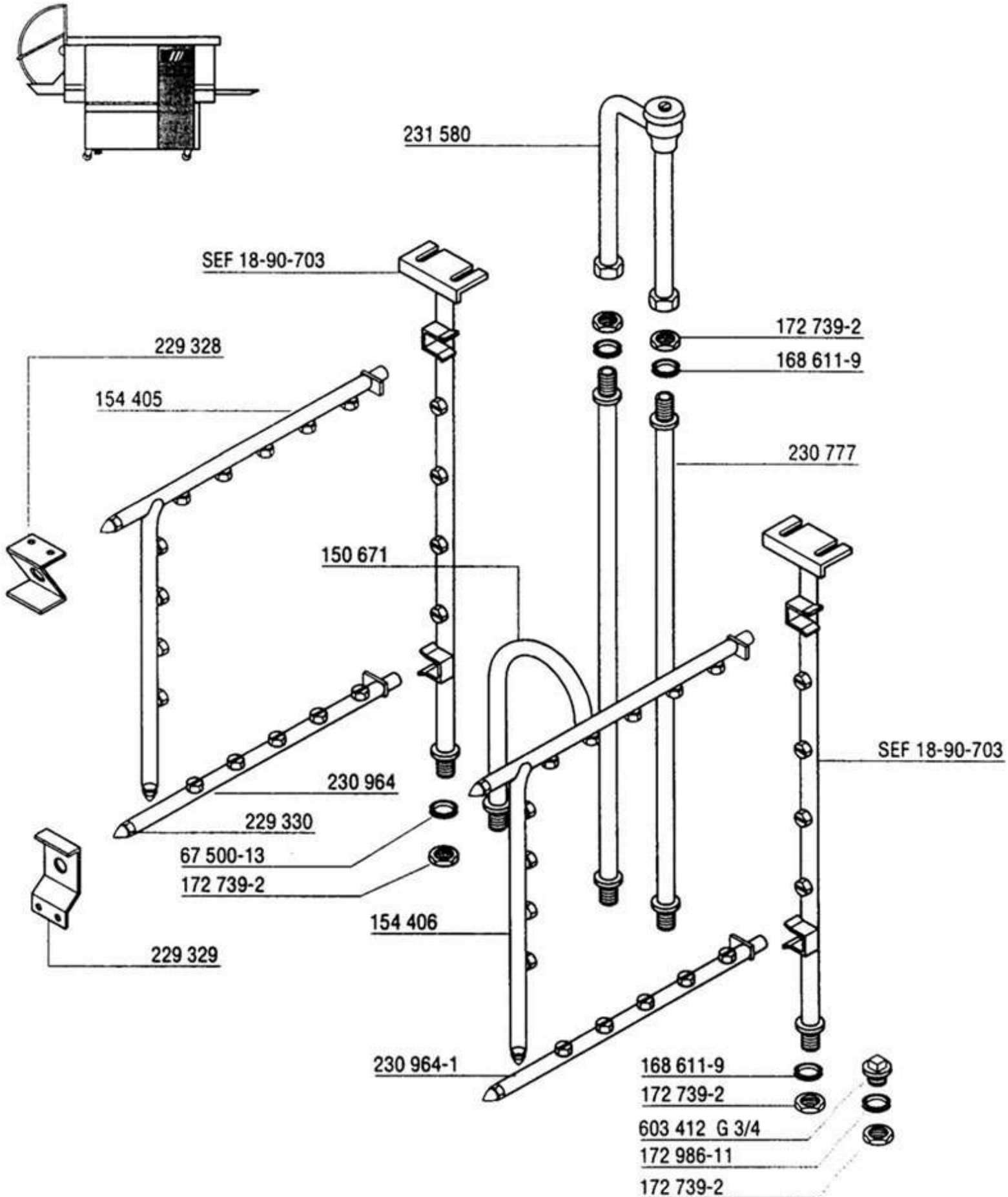

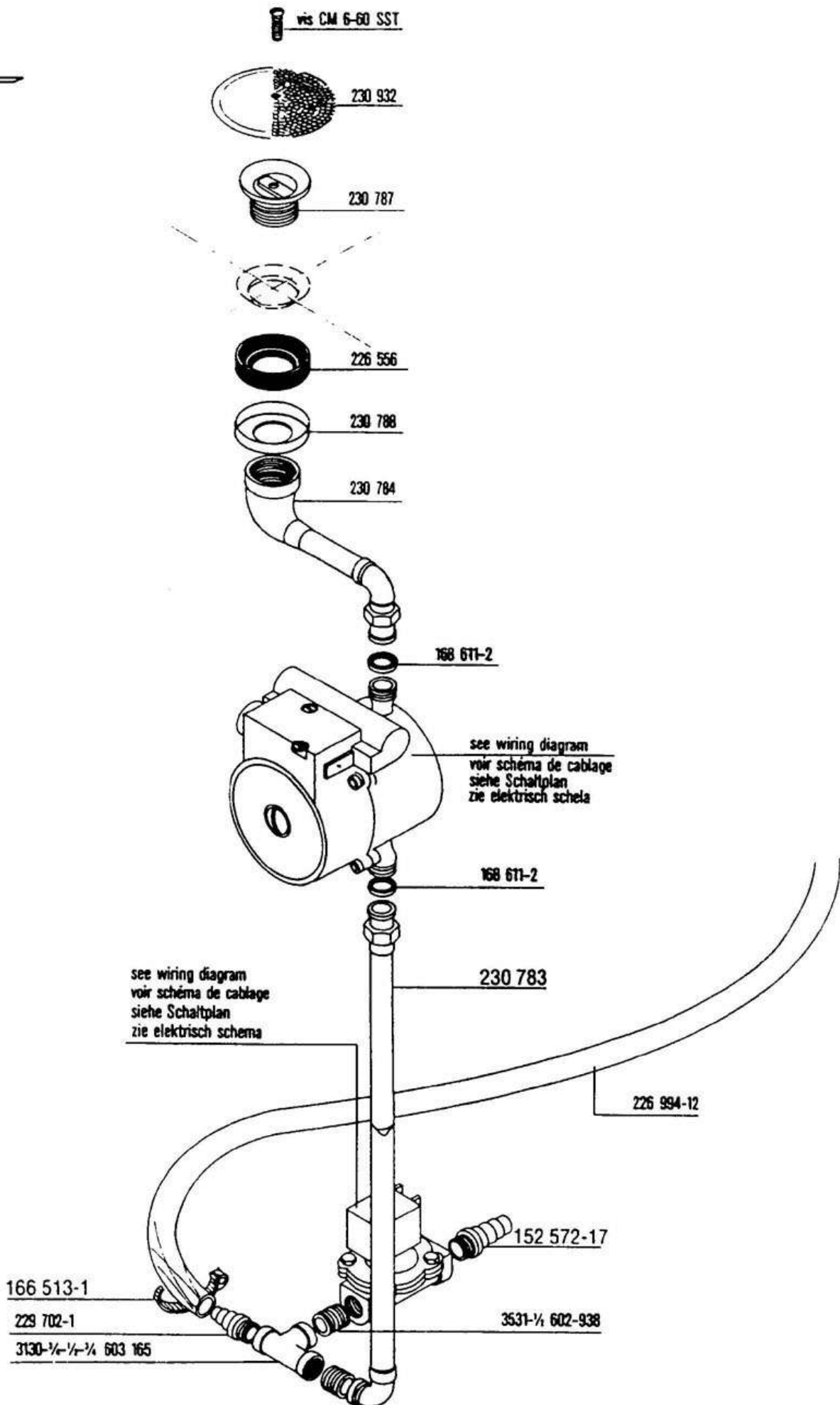
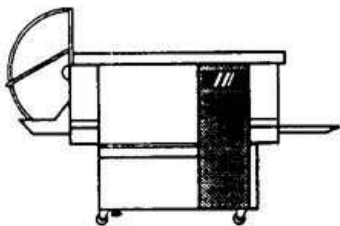

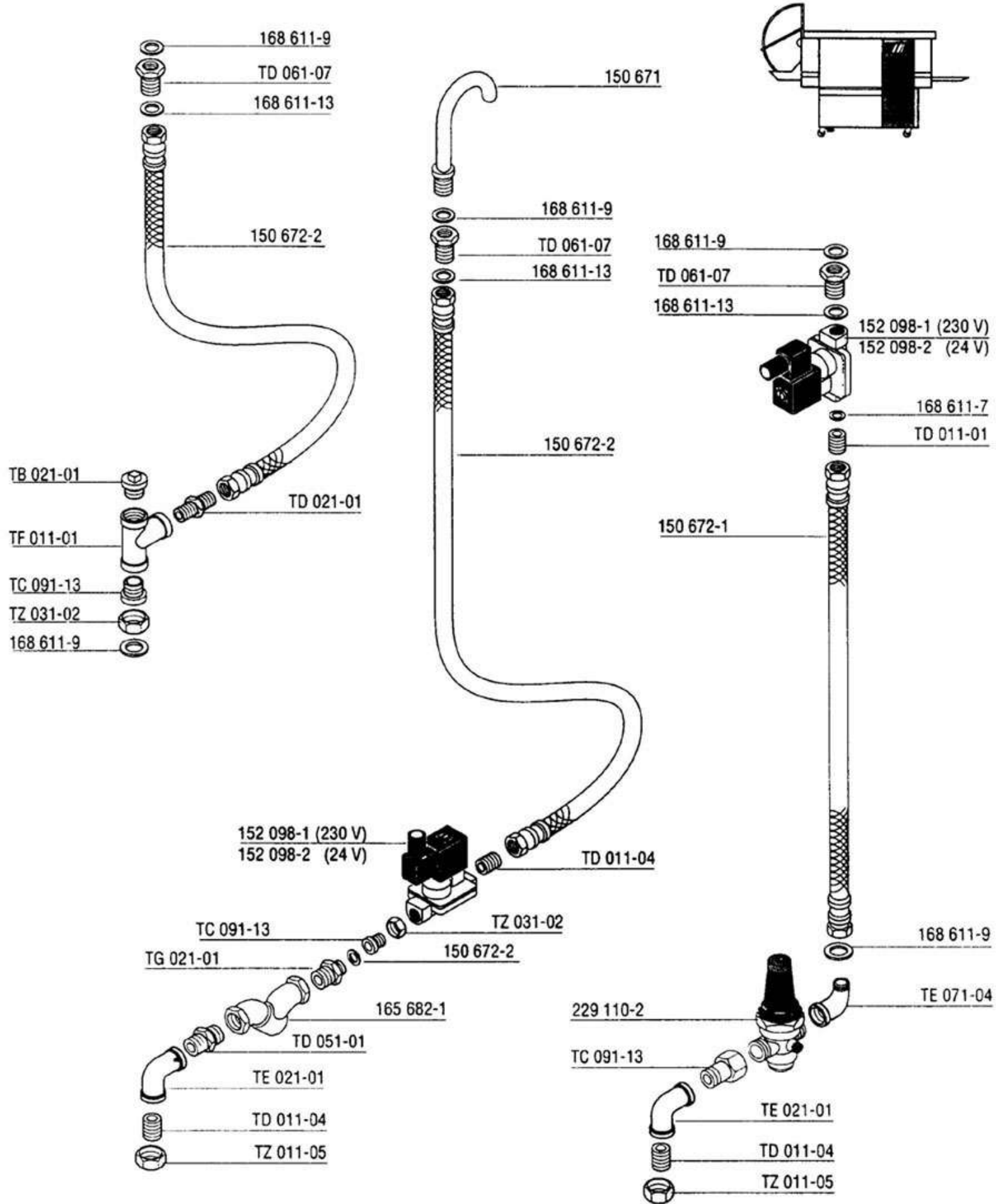

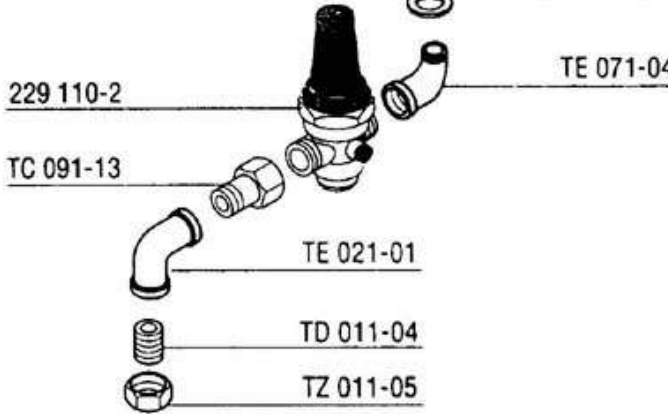
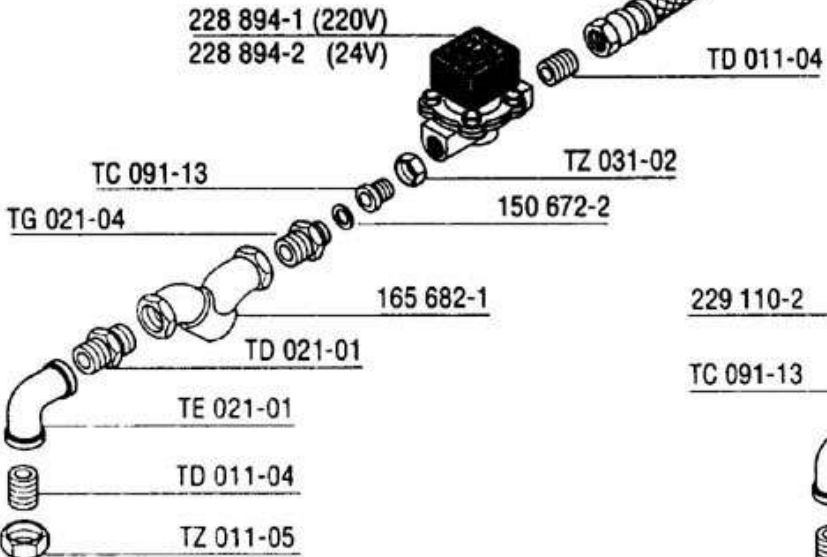
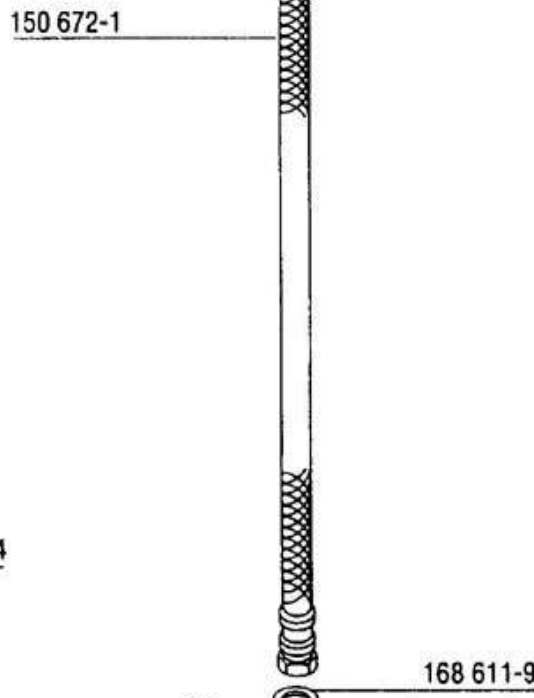
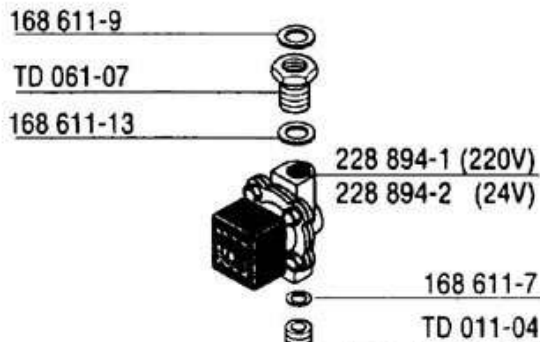
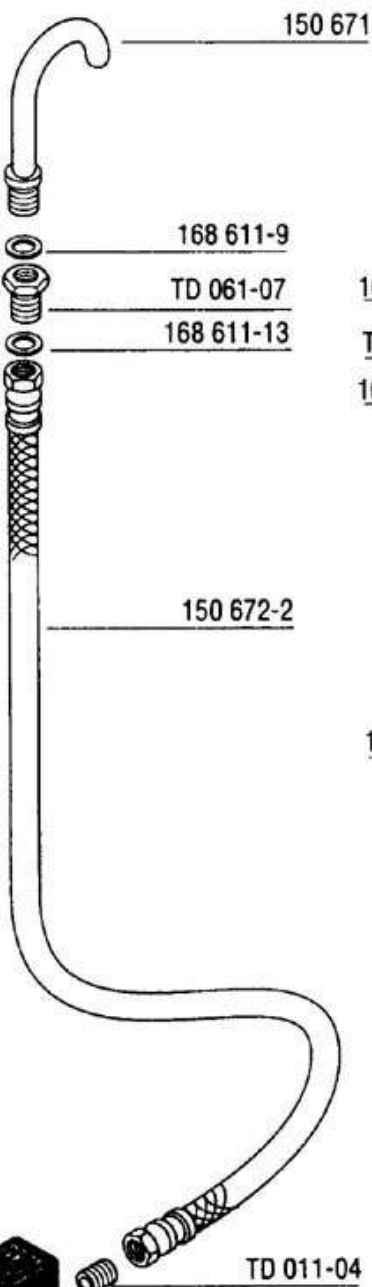
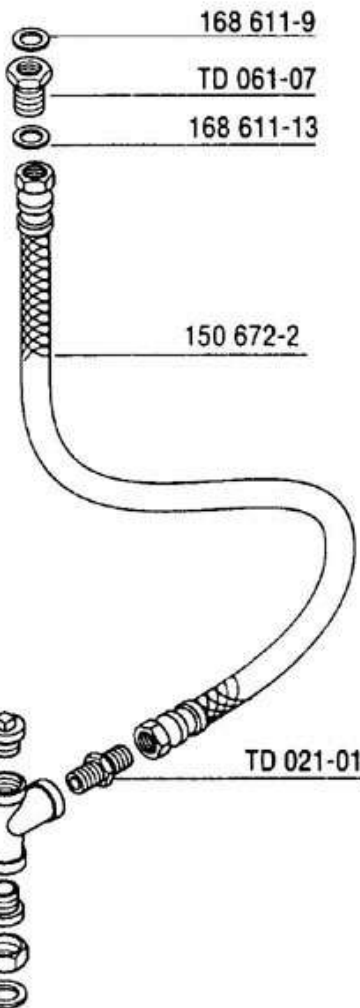
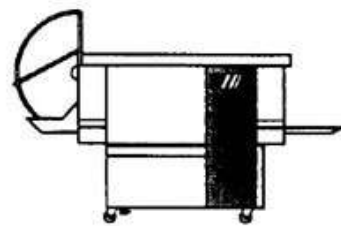

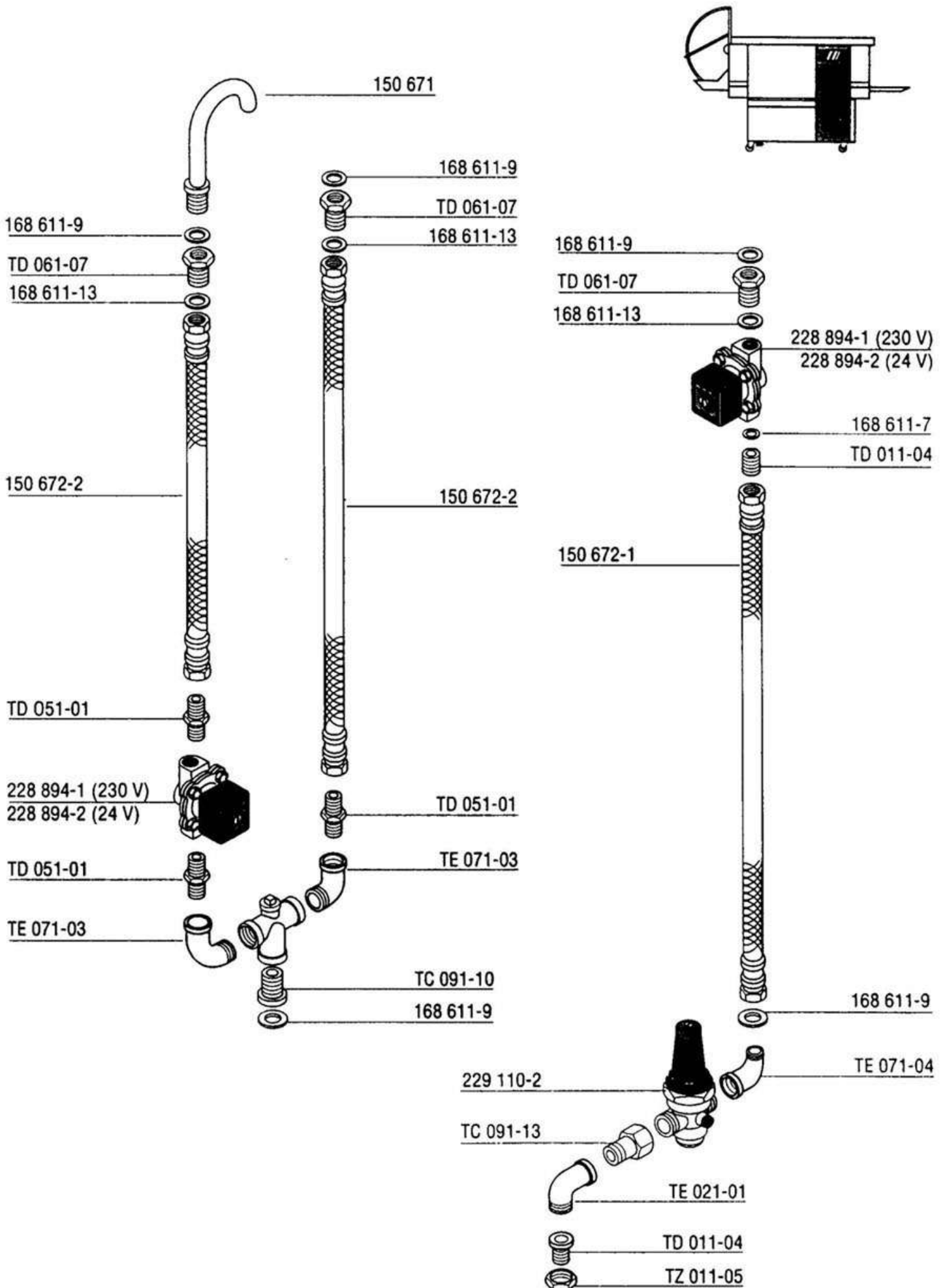



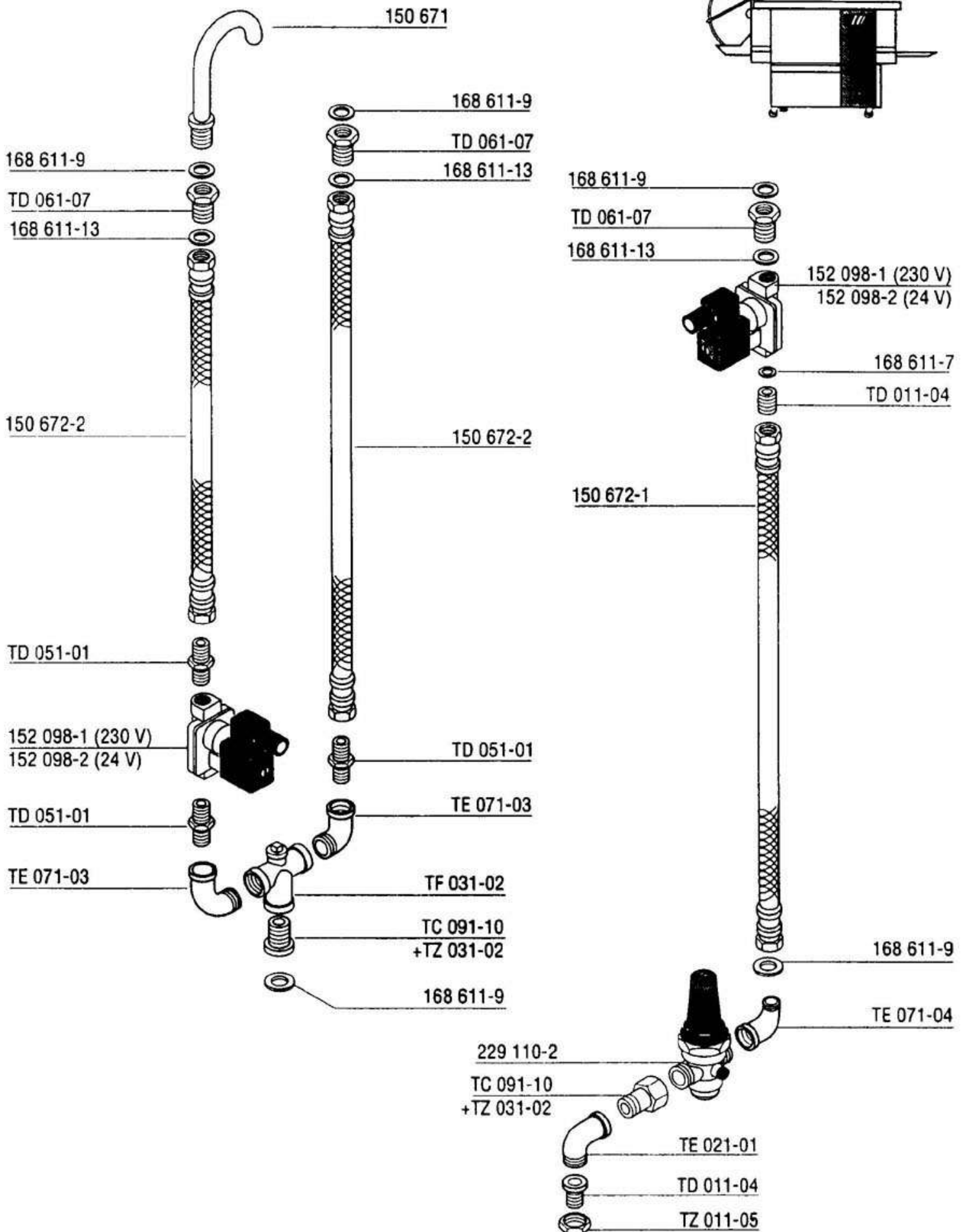

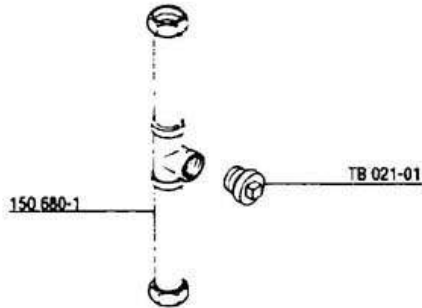
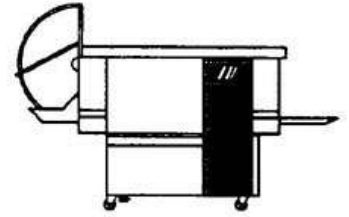

BOOSTER INLET F / G / EXPORT  
 ENTREE CHAUDIERE F / G / EXPORT  
 DURCHLAUFERHITZER ZULAUF F / G / EXPORT

BOOSTER INLET UK  
 ENTREE CHAUDIERE UK  
 DURCHLAUFERHITZER ZULAUF UK

only UK  
 seulement UK  
 nur UK  
 maar UK

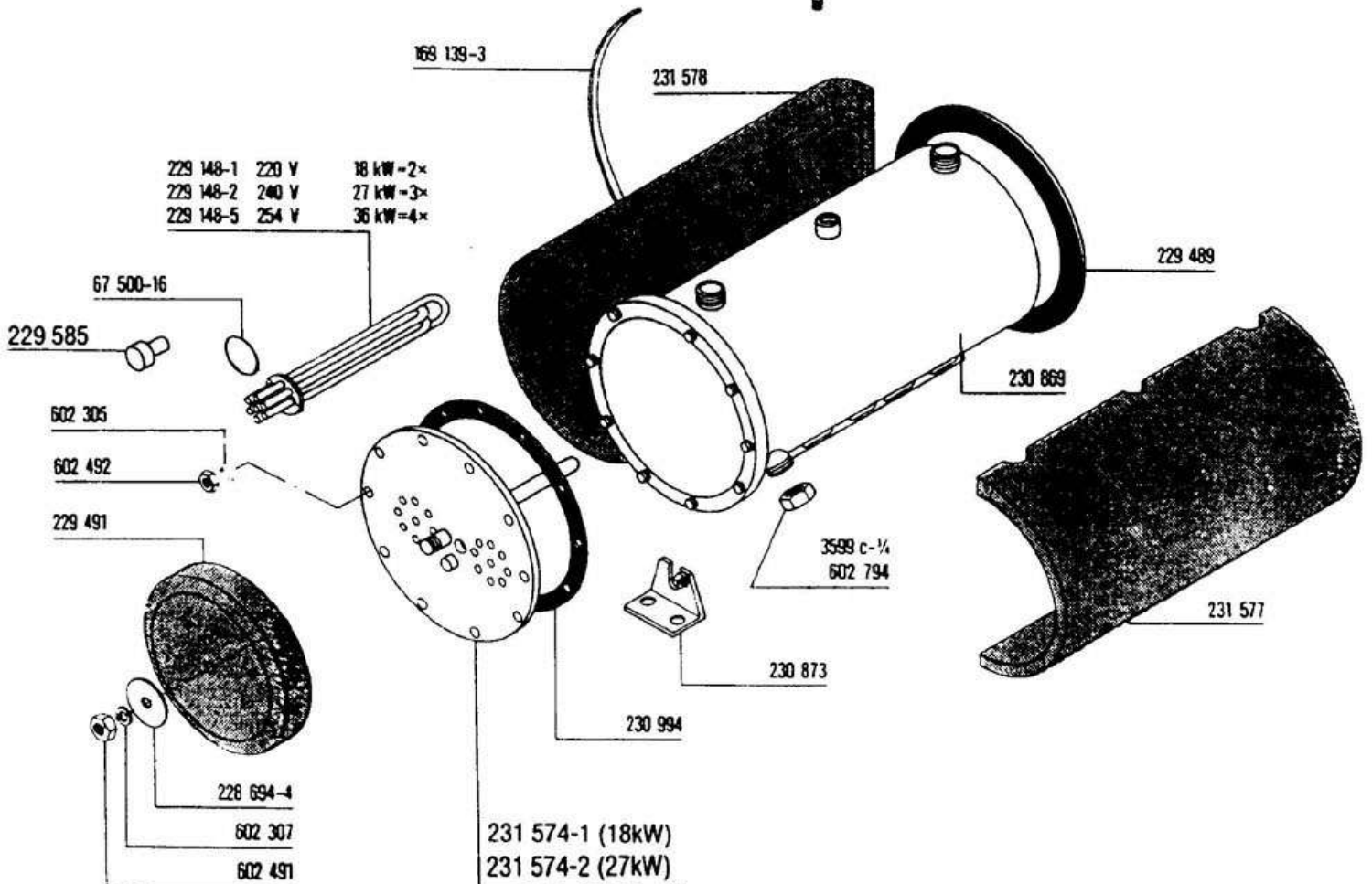
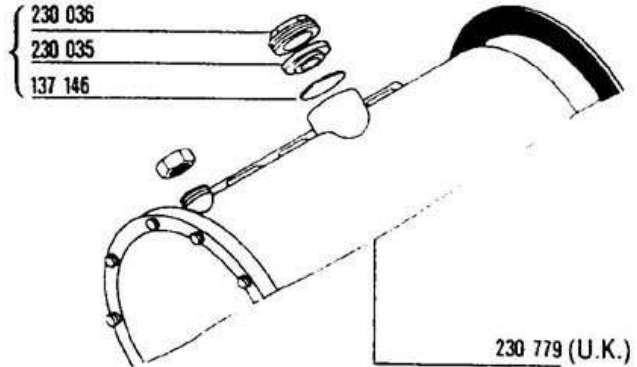
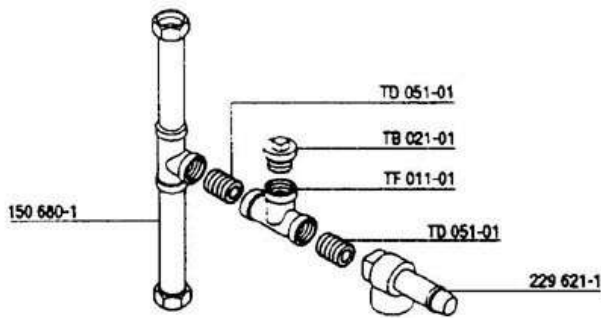

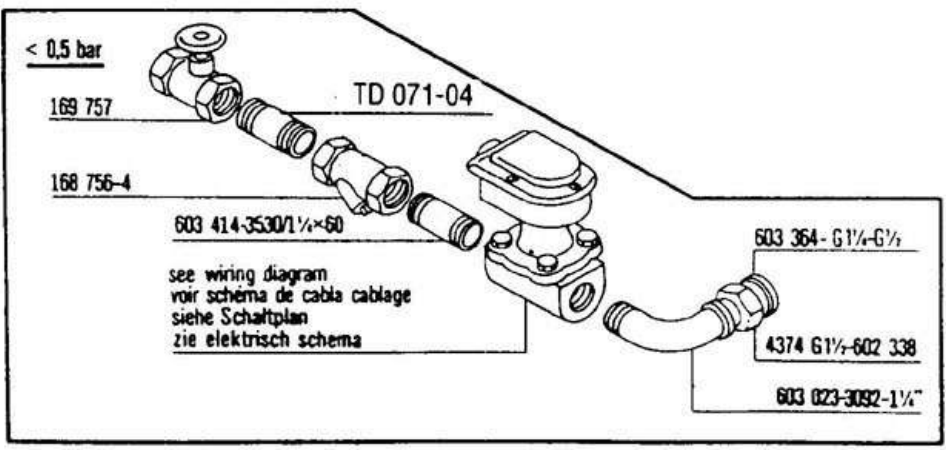
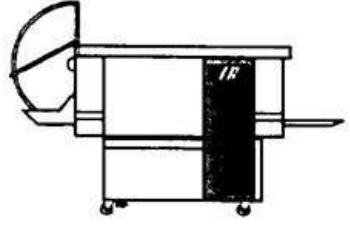
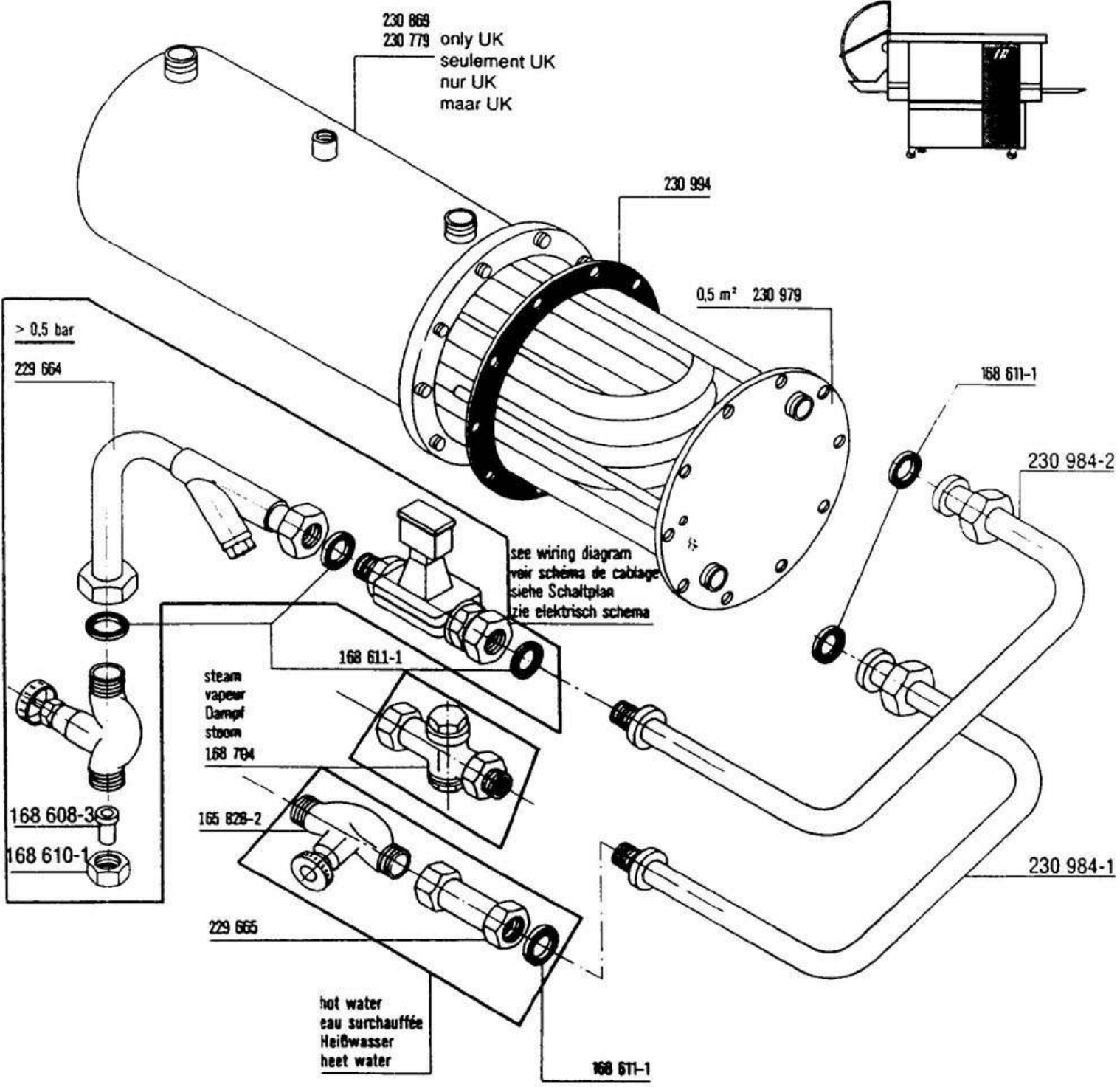

UCX

Rinse booster heater - hot water / steam  
Chaudière - eau surchauffée / vapeur  
Durchlauferhitzer - Heißwasser / Dampf  
Booster - stoom / heet water

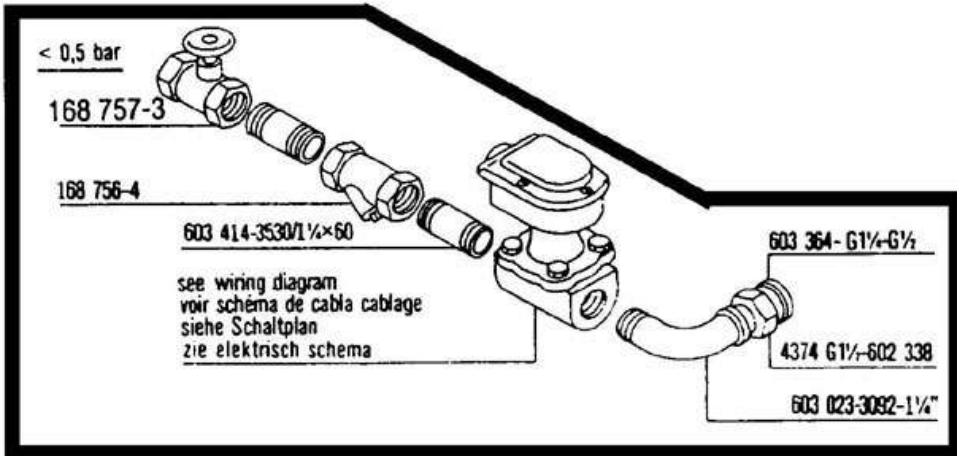
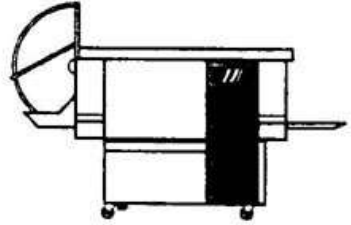

see wiring diagram  
voir schéma de cablage  
siehe Schaltplan  
zie elektrisch schema

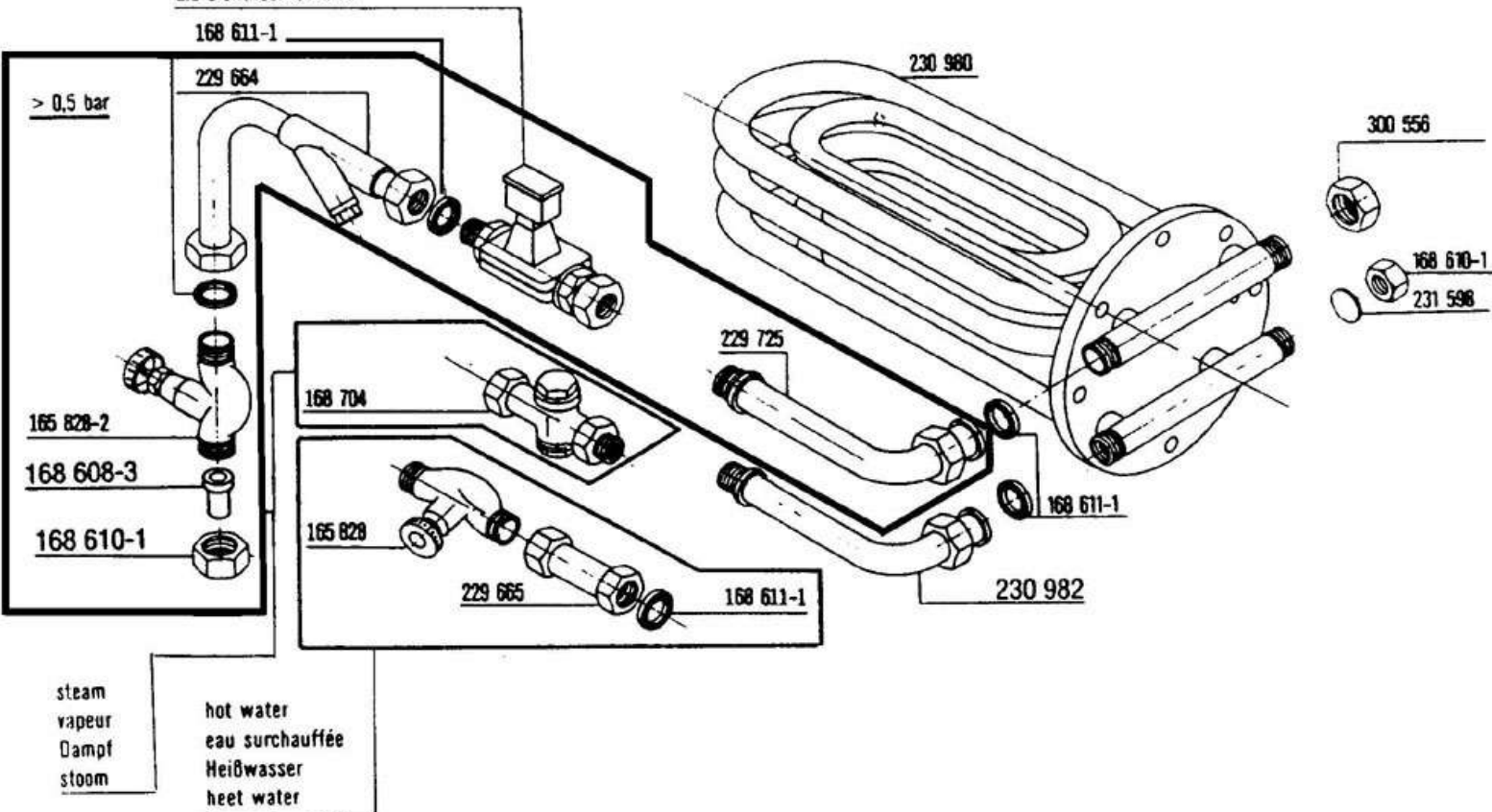



Drive unit  
Entrainement  
Antrieb  
Aandrijving

UCX

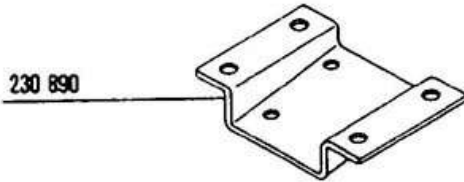
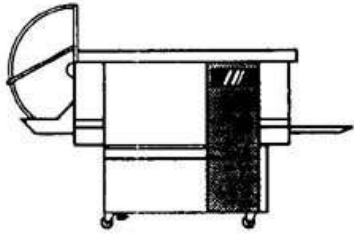

230 890

see wiring diagram  
voir schéma de câblage  
siehe Schaltplan  
zie elektrisch schema

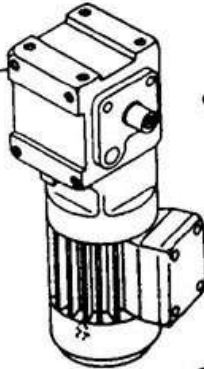

A6x6x30

230 827

603 488 M 12

602 287 ø 8,5

232 815-1

M 12 x 65

232-588-8

231 749

230 830

230 819

231 682

227 873-8

150 589

230 829

230 824

150 589

166 513-1

ø 8,4 602 287

M 8x12 602 575

230 900

230 897

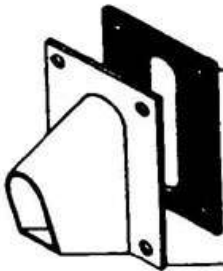

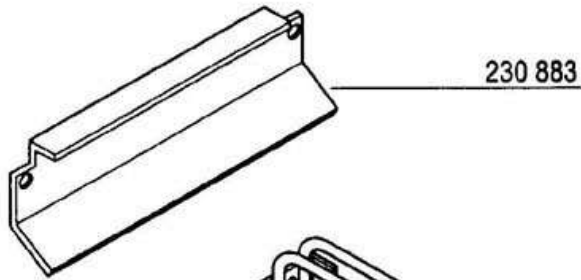
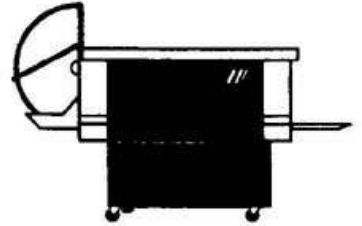

230 883

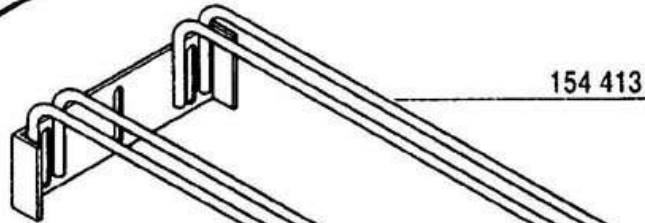

154 413

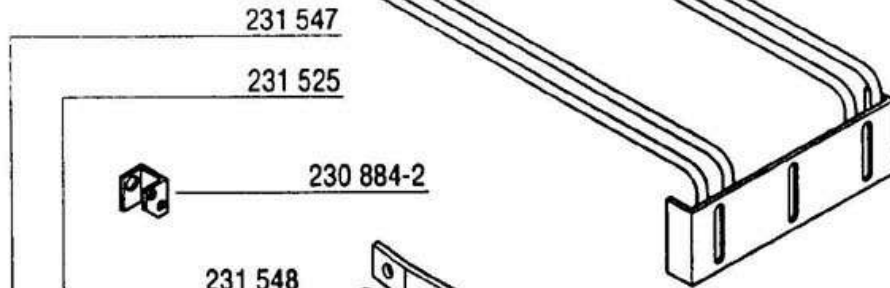

231 547

231 525



230 884-2

231 548

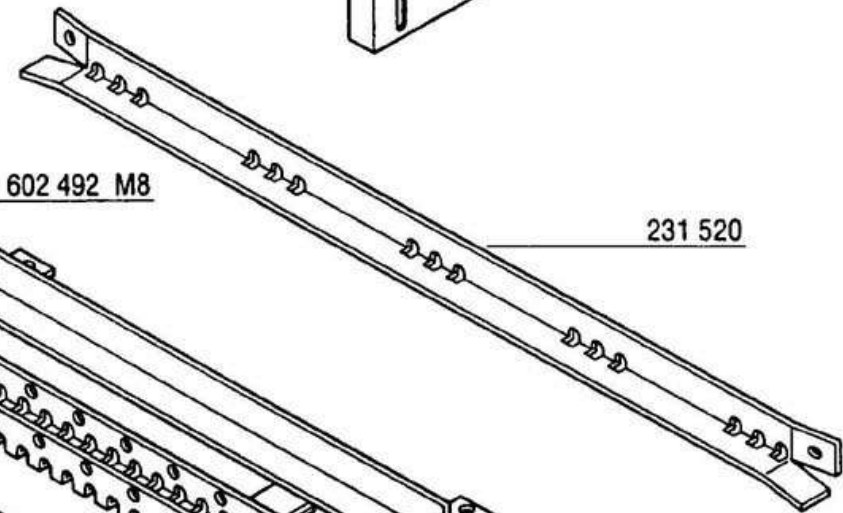

231 520

602 492 M8

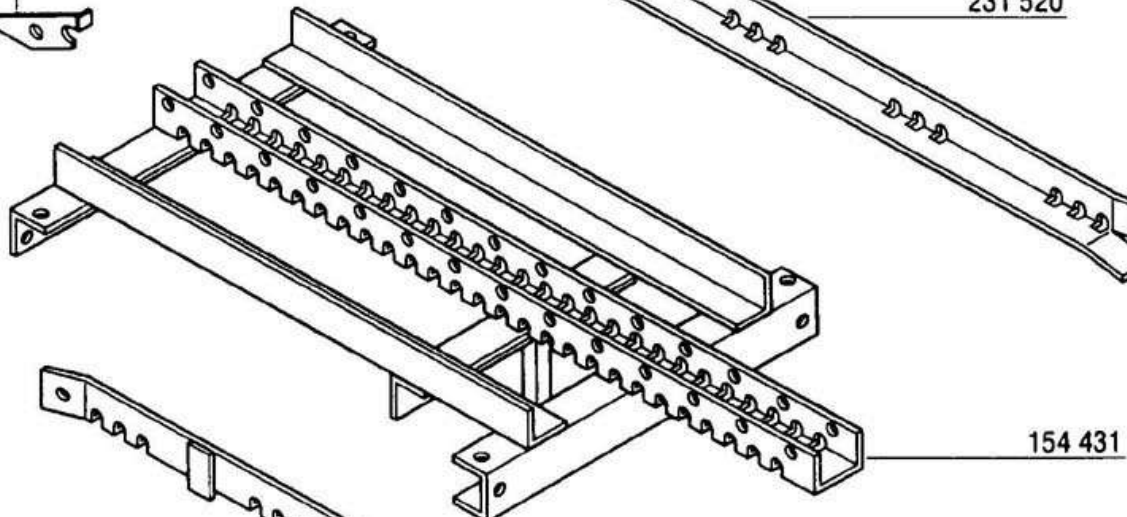

154 431

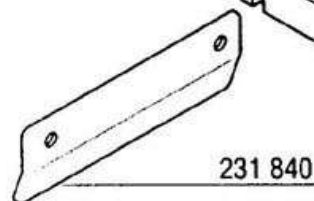

231 840

231 520

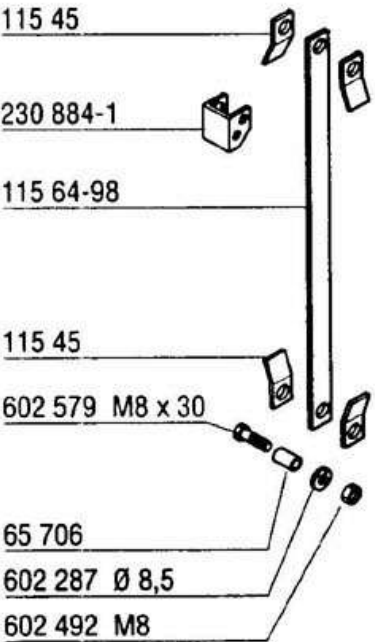

115 45

230 884-1

115 64-98

115 45

602 579 M8 x 30

65 706

602 287 Ø 8,5

602 492 M8



Position of curtains  
Position des rideaux  
Vorhanganordnung  
Volgorde van de gordijnen

UCX

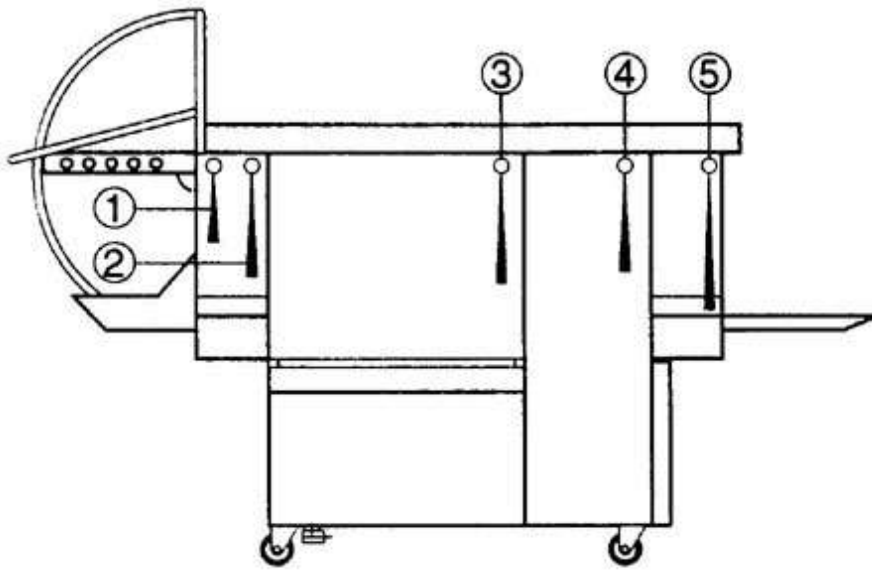

231 540-1

①



231 602-2

231 540-1

②



154 120

231 540-2

③



154 119

231 540-3

④

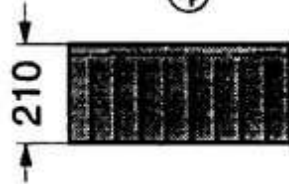

231 602-2

231 540-1

⑤

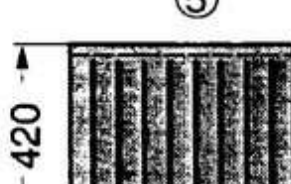

230 781